

FOR LEASE IN TIGARD, OREGON

WASHINGTON GREEN



LOCATION SW Hall Blvd & SW Oleson Rd in Tigard, Oregon

AVAILABLE SPACE 11,358 SF former athletic club

RENTAL RATE \$25.00/SF, NNN

- COMMENTS**
- High visibility location on Hall Blvd adjacent to Washington Square Mall
 - Co-tenants include John's Incredible Pizza, Live Laugh Love Art, and Chipotle
 - Excellent daytime employment and traffic

TRAFFIC COUNTS Hall Blvd – 27,415 ADT (17) | Oleson Rd – 15,083 ADT (17)

DEMOGRAPHICS

	1 MILE	3 MILE	5 MILE
Estimated Population 2019	9,291	142,523	339,211
Population Forecast 2024	9,732	149,212	355,396
Average HH Income	\$80,533	\$94,429	\$109,756
Employees	17,743	76,559	158,680

Source: Regis – SitesUSA (2019)



GEORGE MACOUBRAY | george@cra-nw.com
NICK STANTON | nick@cra-nw.com
503.274.0211

Commercial Realty Advisors NW LLC
733 SW Second Avenue, Suite 200
Portland, Oregon 97204
www.cra-nw.com
Licensed brokers in Oregon & Washington

WASHINGTON SQUARE | TIGARD



SITE PLAN | WASHINGTON GREEN

AVAILABLE
11,358 SF

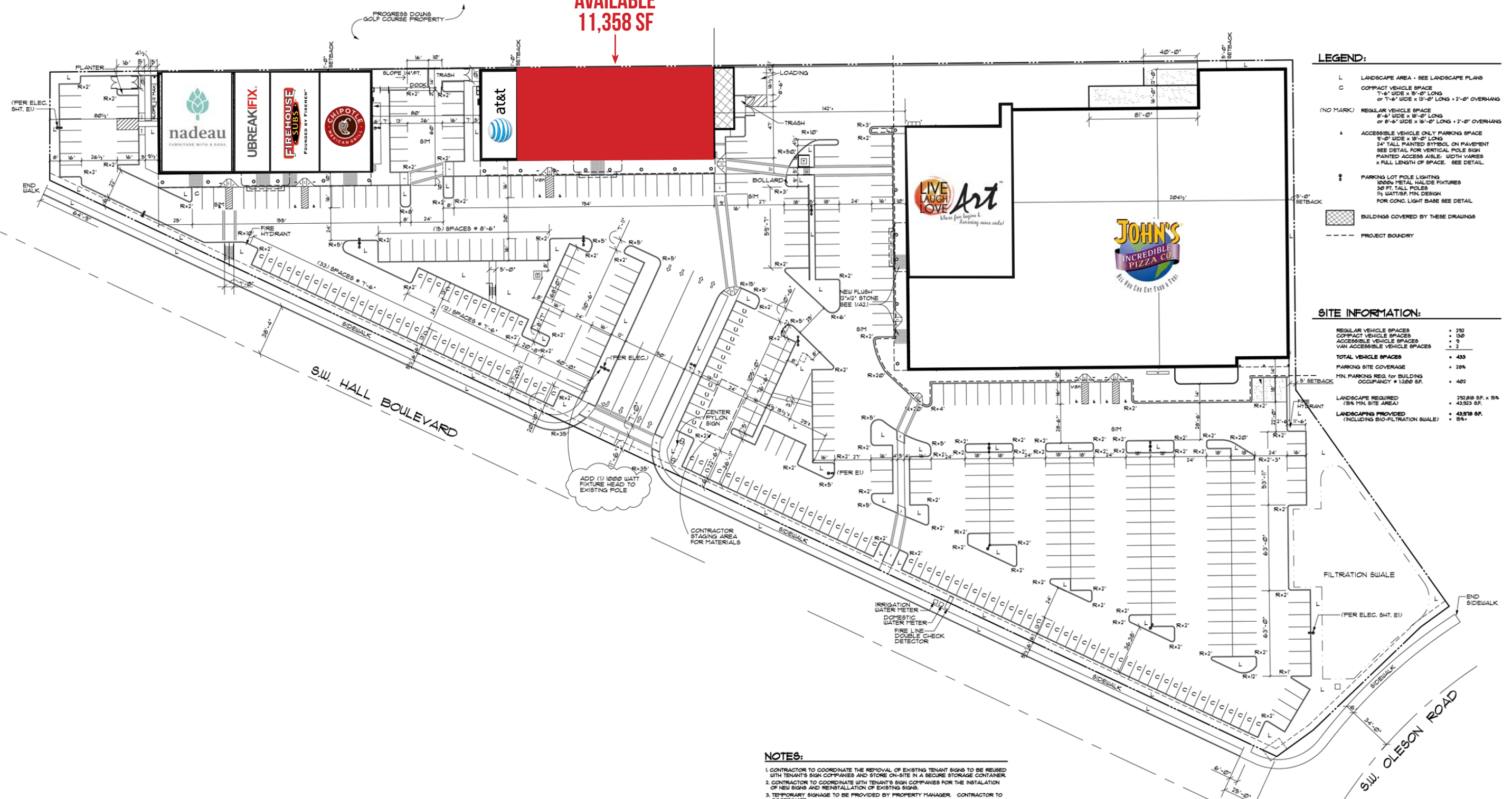

- LEGEND:**
- L LANDSCAPE AREA - SEE LANDSCAPE PLANS
 - C COMPACT VEHICLE SPACE
7'-4" WIDE X 13'-0" LONG + 2'-0" OVERHANG
 - (NO MARK) REGULAR VEHICLE SPACE
8'-6" WIDE X 18'-0" LONG
OR 8'-6" WIDE X 16'-0" LONG + 2'-0" OVERHANG
 - A ACCESSIBLE VEHICLE ONLY PARKING SPACE
3'-0" WIDE X 18'-0" LONG
24" TALL PAINTED SYMBOL ON PAVEMENT
SEE DETAIL FOR VERTICAL POLE SIGN
PAINTED ACCESSIBLE WIDTH VARIES
X FULL LENGTH OF SPACE. SEE DETAIL.
 - PARKING LOT POLE LIGHTING
1000W METAL HALIDE FIXTURES
30 FT. TALL POLES
1/2 WATT/HP. MIN. DESIGN
FOR CONC. LIGHT BASE SEE DETAIL
 - BUILDINGS COVERED BY THESE DRAWINGS
 - PROJECT BOUNDARY

SITE INFORMATION:

REGULAR VEHICLE SPACES	+ 282
COMPACT VEHICLE SPACES	+ 130
ACCESSIBLE VEHICLE SPACES	+ 9
VAN ACCESSIBLE VEHICLE SPACES	+ 2
TOTAL VEHICLE SPACES	+ 433
PARKING SITE COVERAGE	+ 28%
MIN. PARKING REQ. FOR BUILDING OCCUPANCY @ 1200 SF.	+ 402
LANDSCAPE REQUIRED (8% MIN. SITE AREA)	292,898 SF. X 8%
	+ 43,853 SF.
LANDSCAPING PROVIDED (INCLUDING BIO-FILTRATION SWALE)	+ 43,858 SF.
	+ 8%

- NOTES:**
- CONTRACTOR TO COORDINATE THE REMOVAL OF EXISTING TENANT SIGNS TO BE REUSED WITH TENANT'S SIGN COMPANIES AND STORE ON-SITE IN A SECURE STORAGE CONTAINER.
 - CONTRACTOR TO COORDINATE WITH TENANT'S SIGN COMPANIES FOR THE INSTALLATION OF NEW SIGNS AND REINSTALLATION OF EXISTING SIGNS.
 - TEMPORARY SIGNAGE TO BE PROVIDED BY PROPERTY MANAGER. CONTRACTOR TO COORDINATE.
 - CONTRACTOR TO PROVIDE TEMPORARY CONSTRUCTION BARRIERS AT BUSINESS ENTRIES DURING CONSTRUCTION.
 - CONTRACTOR TO PROVIDE A SCHEDULE OF WORK FOR EACH BUILDING TO THE OWNER, PROPERTY MANAGER, AND ARCHITECT FOR EACH PHASE OF THE WORK TO MINIMIZE DISRUPTION OF TENANT BUSINESSES.

1 EXISTING SITE PLAN
A1.1 1"=30'-0"



GROUND FLOOR PLAN | BUILDING 1



TIGARD, OREGON

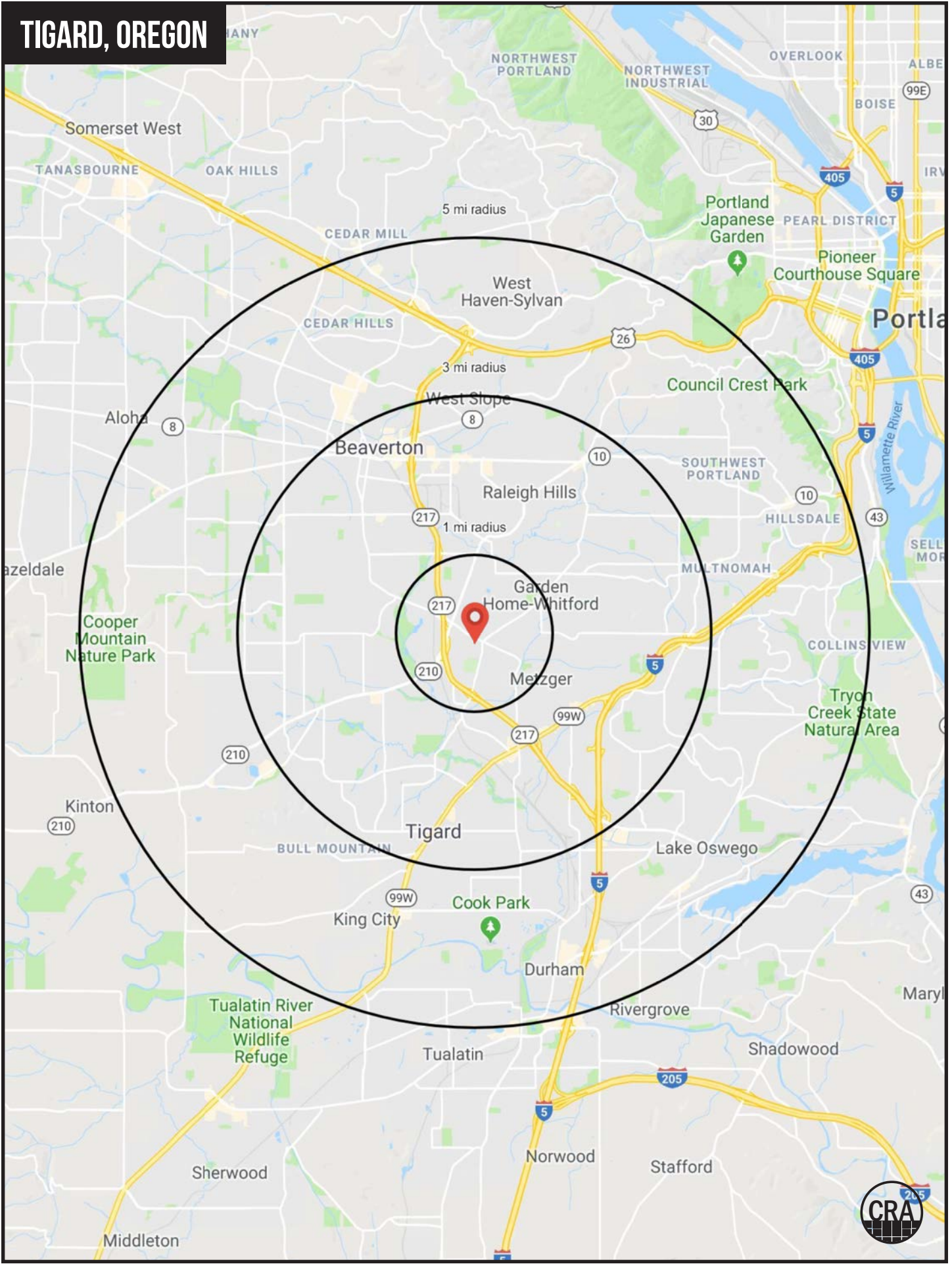

FULL PROFILE

2000-2010 Census, 2019 Estimates with 2024 Projections

Calculated using Weighted Block Centroid from Block Groups



Lat/Lon: 45.4548/-122.7761

RF1

Washington Green

Portland, OR 97223

1 mi radius 3 mi radius 5 mi radius

	1 mi radius	3 mi radius	5 mi radius	
POPULATION	2019 Estimated Population	9,291	142,523	339,211
	2024 Projected Population	9,732	149,212	355,396
	2010 Census Population	8,511	131,178	307,166
	2000 Census Population	7,402	121,544	279,794
	Projected Annual Growth 2019 to 2024	0.9%	0.9%	1.0%
	Historical Annual Growth 2000 to 2019	1.3%	0.9%	1.1%
HOUSEHOLDS	2019 Estimated Households	3,972	60,152	142,028
	2024 Projected Households	4,227	64,015	151,075
	2010 Census Households	3,591	54,867	127,384
	2000 Census Households	3,256	49,779	115,216
	Projected Annual Growth 2019 to 2024	1.3%	1.3%	1.3%
	Historical Annual Growth 2000 to 2019	1.2%	1.1%	1.2%
AGE	2019 Est. Population Under 10 Years	11.0%	10.9%	11.0%
	2019 Est. Population 10 to 19 Years	9.5%	11.0%	11.2%
	2019 Est. Population 20 to 29 Years	12.6%	12.9%	12.7%
	2019 Est. Population 30 to 44 Years	20.8%	21.7%	21.5%
	2019 Est. Population 45 to 59 Years	20.1%	21.0%	20.9%
	2019 Est. Population 60 to 74 Years	16.6%	15.8%	16.1%
	2019 Est. Population 75 Years or Over	9.4%	6.7%	6.6%
	2019 Est. Median Age	41.5	39.7	39.9
MARITAL STATUS & GENDER	2019 Est. Male Population	48.3%	48.9%	48.8%
	2019 Est. Female Population	51.7%	51.1%	51.2%
	2019 Est. Never Married	31.1%	30.8%	30.3%
	2019 Est. Now Married	45.0%	47.1%	49.7%
	2019 Est. Separated or Divorced	20.3%	17.9%	16.1%
	2019 Est. Widowed	3.6%	4.1%	3.9%
INCOME	2019 Est. HH Income \$200,000 or More	6.6%	8.1%	11.2%
	2019 Est. HH Income \$150,000 to \$199,999	5.6%	9.8%	11.0%
	2019 Est. HH Income \$100,000 to \$149,999	19.1%	18.3%	18.0%
	2019 Est. HH Income \$75,000 to \$99,999	13.4%	14.9%	14.5%
	2019 Est. HH Income \$50,000 to \$74,999	15.7%	16.7%	16.3%
	2019 Est. HH Income \$35,000 to \$49,999	14.0%	11.3%	10.3%
	2019 Est. HH Income \$25,000 to \$34,999	6.5%	7.1%	6.6%
	2019 Est. HH Income \$15,000 to \$24,999	11.0%	7.3%	6.1%
	2019 Est. HH Income Under \$15,000	8.1%	6.5%	6.0%
	2019 Est. Average Household Income	\$80,533	\$94,429	\$109,756
	2019 Est. Median Household Income	\$63,612	\$79,988	\$88,240
	2019 Est. Per Capita Income	\$34,800	\$39,950	\$46,043
	2019 Est. Total Businesses	1,932	8,615	16,695
	2019 Est. Total Employees	17,743	76,559	158,680

This report was produced using data from private and government sources deemed to be reliable. The information herein is provided without representation or warranty.

FULL PROFILE

2000-2010 Census, 2019 Estimates with 2024 Projections

Calculated using Weighted Block Centroid from Block Groups



Lat/Lon: 45.4548/-122.7761

RF1

Washington Green

Portland, OR 97223

1 mi radius 3 mi radius 5 mi radius

	1 mi radius	3 mi radius	5 mi radius	
RACE	2019 Est. White	78.7%	76.3%	77.0%
	2019 Est. Black	3.6%	3.0%	2.8%
	2019 Est. Asian or Pacific Islander	5.7%	8.4%	9.1%
	2019 Est. American Indian or Alaska Native	0.5%	0.6%	0.6%
	2019 Est. Other Races	11.4%	11.6%	10.5%
HISPANIC	2019 Est. Hispanic Population	1,236	20,651	43,106
	2019 Est. Hispanic Population	13.3%	14.5%	12.7%
	2024 Proj. Hispanic Population	13.9%	15.0%	13.1%
	2010 Hispanic Population	12.6%	13.2%	11.5%
EDUCATION (Adults 25 or Older)	2019 Est. Adult Population (25 Years or Over)	6,878	103,172	245,131
	2019 Est. Elementary (Grade Level 0 to 8)	4.9%	3.4%	2.8%
	2019 Est. Some High School (Grade Level 9 to 11)	4.7%	3.7%	3.1%
	2019 Est. High School Graduate	18.7%	15.6%	14.3%
	2019 Est. Some College	23.6%	21.4%	20.1%
	2019 Est. Associate Degree Only	7.1%	7.6%	7.7%
	2019 Est. Bachelor Degree Only	26.0%	31.5%	31.9%
	2019 Est. Graduate Degree	14.9%	16.8%	20.1%
HOUSING	2019 Est. Total Housing Units	4,060	61,304	144,954
	2019 Est. Owner-Occupied	52.4%	55.1%	58.7%
	2019 Est. Renter-Occupied	45.4%	43.0%	39.3%
	2019 Est. Vacant Housing	2.2%	1.9%	2.0%
HOMES BUILT BY YEAR	2019 Homes Built 2010 or later	6.4%	4.4%	5.6%
	2019 Homes Built 2000 to 2009	8.8%	10.0%	11.2%
	2019 Homes Built 1990 to 1999	12.0%	16.1%	18.1%
	2019 Homes Built 1980 to 1989	9.0%	16.5%	14.9%
	2019 Homes Built 1970 to 1979	25.2%	24.0%	21.3%
	2019 Homes Built 1960 to 1969	18.3%	11.8%	10.8%
	2019 Homes Built 1950 to 1959	12.4%	8.2%	8.2%
	2019 Homes Built Before 1949	5.8%	7.3%	7.9%
HOME VALUES	2019 Home Value \$1,000,000 or More	1.5%	1.3%	2.3%
	2019 Home Value \$500,000 to \$999,999	20.9%	27.2%	32.3%
	2019 Home Value \$400,000 to \$499,999	28.5%	26.5%	25.5%
	2019 Home Value \$300,000 to \$399,999	34.6%	32.3%	29.7%
	2019 Home Value \$200,000 to \$299,999	17.1%	15.5%	13.5%
	2019 Home Value \$150,000 to \$199,999	1.8%	1.8%	1.7%
	2019 Home Value \$100,000 to \$149,999	1.7%	1.5%	1.2%
	2019 Home Value \$50,000 to \$99,999	1.6%	1.0%	1.1%
	2019 Home Value \$25,000 to \$49,999	0.3%	0.4%	0.6%
	2019 Home Value Under \$25,000	0.9%	1.3%	1.1%
	2019 Median Home Value	\$398,618	\$415,472	\$444,096
2019 Median Rent	\$1,216	\$1,188	\$1,202	

This report was produced using data from private and government sources deemed to be reliable. The information herein is provided without representation or warranty.

FULL PROFILE

2000-2010 Census, 2019 Estimates with 2024 Projections

Calculated using Weighted Block Centroid from Block Groups



Lat/Lon: 45.4548/-122.7761

RF1

Washington Green

Portland, OR 97223

1 mi radius 3 mi radius 5 mi radius

	1 mi radius	3 mi radius	5 mi radius	
LABOR FORCE	2019 Est. Labor Population Age 16 Years or Over	7,732	117,368	278,338
	2019 Est. Civilian Employed	68.7%	67.2%	67.0%
	2019 Est. Civilian Unemployed	1.4%	2.4%	2.1%
	2019 Est. in Armed Forces	-	-	-
	2019 Est. not in Labor Force	29.8%	30.4%	30.8%
	2019 Labor Force Males	47.8%	48.4%	48.2%
	2019 Labor Force Females	52.2%	51.6%	51.8%
OCCUPATION	2019 Occupation: Population Age 16 Years or Over	5,314	78,893	186,508
	2019 Mgmt, Business, & Financial Operations	24.7%	19.6%	21.2%
	2019 Professional, Related	21.2%	26.9%	28.3%
	2019 Service	16.6%	13.9%	13.9%
	2019 Sales, Office	23.5%	24.2%	22.7%
	2019 Farming, Fishing, Forestry	1.5%	0.5%	0.4%
	2019 Construction, Extraction, Maintenance	5.3%	5.6%	4.7%
	2019 Production, Transport, Material Moving	7.2%	9.3%	8.7%
	2019 White Collar Workers	69.4%	70.7%	72.2%
	2019 Blue Collar Workers	30.6%	29.3%	27.8%
TRANSPORTATION TO WORK	2019 Drive to Work Alone	66.5%	69.9%	70.2%
	2019 Drive to Work in Carpool	11.7%	9.1%	9.3%
	2019 Travel to Work by Public Transportation	5.7%	7.7%	7.0%
	2019 Drive to Work on Motorcycle	0.2%	0.3%	0.2%
	2019 Walk or Bicycle to Work	5.7%	4.3%	4.1%
	2019 Other Means	0.2%	0.4%	0.5%
	2019 Work at Home	10.0%	8.3%	8.7%
TRAVEL TIME	2019 Travel to Work in 14 Minutes or Less	27.9%	22.2%	21.1%
	2019 Travel to Work in 15 to 29 Minutes	47.2%	42.3%	42.8%
	2019 Travel to Work in 30 to 59 Minutes	25.3%	32.2%	32.9%
	2019 Travel to Work in 60 Minutes or More	4.7%	5.5%	5.2%
	2019 Average Travel Time to Work	20.8	23.0	23.2
CONSUMER EXPENDITURE	2019 Est. Total Household Expenditure	\$240.95 M	\$4.06 B	\$10.66 B
	2019 Est. Apparel	\$8.45 M	\$144.11 M	\$380.31 M
	2019 Est. Contributions, Gifts	\$13.69 M	\$235.47 M	\$634.54 M
	2019 Est. Education, Reading	\$7.55 M	\$134.13 M	\$366.24 M
	2019 Est. Entertainment	\$13.53 M	\$231.24 M	\$612.09 M
	2019 Est. Food, Beverages, Tobacco	\$37.08 M	\$620.58 M	\$1.62 B
	2019 Est. Furnishings, Equipment	\$8.41 M	\$143.72 M	\$379.66 M
	2019 Est. Health Care, Insurance	\$22.17 M	\$369.45 M	\$961.79 M
	2019 Est. Household Operations, Shelter, Utilities	\$78.46 M	\$1.31 B	\$3.43 B
	2019 Est. Miscellaneous Expenses	\$4.56 M	\$77.13 M	\$202.84 M
	2019 Est. Personal Care	\$3.24 M	\$54.67 M	\$143.28 M
	2019 Est. Transportation	\$43.83 M	\$739.49 M	\$1.93 B

This report was produced using data from private and government sources deemed to be reliable. The information herein is provided without representation or warranty.



INITIAL AGENCY DISCLOSURE (OAR 863-015-215(4))

Consumers: This pamphlet describes the legal obligations of Oregon real estate licensees to consumers. Real estate brokers and principal real estate brokers are required to provide this information to you when they first contact you. A licensed real estate broker or principal broker need not provide the pamphlet to a party who has, or may be reasonably assumed to have, received a copy of the pamphlet from another broker. This pamphlet is informational only. Neither the pamphlet nor its delivery to you may be interpreted as evidence of intent to create an agency relationship between you and a broker or a principal broker.

Real Estate Agency Relationships

An "agency" relationship is a voluntary legal relationship in which a licensed real estate broker or principal broker (the "agent") agrees to act on behalf of a buyer or a seller (the "client") in a real estate transaction. Oregon law provides for three types of agency relationships between real estate agents and their clients:

Seller's Agent -- Represents the seller only.

Buyer's Agent -- Represents the buyer only.

Disclosed Limited Agent -- Represents both the buyer and seller, or multiple buyers who want to purchase the same property. This can be done only with the written permission of all clients.

The actual agency relationships between the seller, buyer and their agents in a real estate transaction must be acknowledged at the time an offer to purchase is made. Please read this pamphlet carefully before entering into an agency relationship with a real estate agent.

Definition of "Confidential Information"

Generally, licensees must maintain confidential information about their clients. "Confidential information" is information communicated to a real estate licensee or the licensee's agent by the buyer or seller of one to four residential units regarding the real property transaction, including but not limited to price, terms, financial qualifications or motivation to buy or sell. "Confidential information" does not mean information that:

1. The buyer instructs the licensee or the licensee's agent to disclose about the buyer to the seller, or the seller instructs the licensee or the licensee's agent to disclose about the seller to the buyer; and
2. The licensee or the licensee's agent knows or should know failure to disclose would constitute fraudulent representation.

Duties and Responsibilities of a Seller's Agent

Under a written listing agreement to sell property, an agent represents only the seller unless the seller agrees in writing to allow the agent to also represent the buyer.

An agent who represents only the seller owes the following affirmative duties to the seller, the other parties and the other parties' agents involved in a real estate transaction:

1. To deal honestly and in good faith;
2. To present all written offers, notices and other communications to and from the parties in a timely manner without regard to whether the property is subject to a contract for sale or the buyer is already a party to a contract to purchase; and
3. To disclose material facts known by the agent and not apparent or readily ascertainable to a party.

A seller's agent owes the seller the following affirmative duties:

1. To exercise reasonable care and diligence;
2. To account in a timely manner for money and property received from or on behalf of the seller;
3. To be loyal to the seller by not taking action that is adverse or detrimental to the seller's interest in a transaction;
4. To disclose in a timely manner to the seller any conflict of interest, existing or contemplated;
5. To advise the seller to seek expert advice on matters related to the transaction that are beyond the agent's expertise;
6. To maintain confidential information from or about the seller except under subpoena or court order, even after termination of the agency relationship; and
7. Unless agreed otherwise in writing, to make a continuous, good faith effort to find a buyer for the property, except that a seller's agent is not required to seek additional offers to purchase the property while the property is subject to a contract for sale.

None of these affirmative duties of an agent may be waived, except (7). The affirmative duty listed in (7) can only be waived by written agreement between seller and agent.

Under Oregon law, a seller's agent may show properties owned by another seller to a prospective buyer and may list competing properties for sale without breaching any affirmative duty to the seller.

Unless agreed to in writing, an agent has no duty to investigate matters that are outside the scope of the agent's expertise, including but not limited to investigation of the condition of property, the legal status of the title or the seller's past conformance with law.

Duties and Responsibilities of a Buyer's Agent

An agent, other than the seller's agent, may agree to act as the buyer's agent only. The buyer's agent is not representing the seller, even if the buyer's agent is receiving compensation for services rendered, either in full or in part, from the seller or through the seller's agent.

An agent who represents only the buyer owes the following affirmative duties to the buyer, the other parties and the other parties' agents involved in a real estate transaction:

1. To deal honestly and in good faith;
2. To present all written offers, notices and other communications to and from the parties in a timely manner without regard to whether the property is subject to a contract for sale or the buyer is already a party to a contract to purchase; and
3. To disclose material facts known by the agent and not apparent or readily ascertainable to a party.

A buyer's agent owes the buyer the following affirmative duties:

1. To exercise reasonable care and diligence;
2. To account in a timely manner for money and property received from or on behalf of the buyer;
3. To be loyal to the buyer by not taking action that is adverse or detrimental to the buyer's interest in a transaction;
4. To disclose in a timely manner to the buyer any conflict of interest, existing or contemplated;
5. To advise the buyer to seek expert advice on matters related to the transaction that are beyond the agent's expertise;
6. To maintain confidential information from or about the buyer except under subpoena or court order, even after termination of the agency relationship; and
7. Unless agreed otherwise in writing, to make a continuous, good faith effort to find property for the buyer, except that a buyer's agent is not required to seek additional properties for the buyer while the buyer is subject to a contract for purchase.

None of these affirmative duties of an agent may be waived, except (7). The affirmative duty listed in (7) can only be waived by written agreement between buyer and agent.

Under Oregon law, a buyer's agent may show properties in which the buyer is interested to other prospective buyers without breaching an affirmative duty to the buyer.

Unless agreed to in writing, an agent has no duty to investigate matters that are outside the scope of the agent's expertise, including but not limited to investigation of the condition of property, the legal status of the title or the seller's past conformance with law.

Duties and Responsibilities of an Agent Who Represents More than One Client in a Transaction

One agent may represent both the seller and the buyer in the same transaction, or multiple buyers who want to purchase the same property, only under a written "Disclosed Limited Agency Agreement" signed by the seller and buyer(s).

Disclosed Limited Agents have the following duties to their clients:

- a. To the seller, the duties listed above for a seller's agent;
- b. To the buyer, the duties listed above for a buyer's agent; and
- c. To both buyer and seller, except with express written permission of the respective person, the duty not to disclose to the other person:
 - i. That the seller will accept a price lower or terms less favorable than the listing price or terms;
 - ii. That the buyer will pay a price greater or terms more favorable than the offering price or terms; or
 - iii. Confidential information as defined above.

Unless agreed to in writing, an agent has no duty to investigate matters that are outside the scope of the agent's expertise.

When different agents associated with the same principal broker (a real estate licensee who supervises other agents) establish agency relationships with different parties to the same transaction, only the principal broker will act as a Disclosed Limited Agent for both the buyer and seller. The other agents continue to represent only the party with whom the agents have already established an agency relationship unless all parties agree otherwise in writing. The principal real estate broker and the real estate licensees representing either seller or buyer shall owe the following duties to the seller and buyer:

1. To disclose a conflict of interest in writing to all parties;
2. To take no action that is adverse or detrimental to either party's interest in the transaction; and
3. To obey the lawful instructions of both parties.

No matter whom they represent, an agent must disclose information the agent knows or should know that failure to disclose would constitute fraudulent misrepresentation.

You are encouraged to discuss the above information with the licensee delivering this pamphlet to you. If you intend for that licensee, or any other Oregon real estate licensee, to represent you as a Seller's Agent, Buyer's Agent, or Disclosed Limited Agent, you should have a specific discussion with the agent about the nature and scope of the agency relationship. Whether you are a buyer or seller, you cannot make a licensee your agent without the licensee's knowledge and consent, and an agent cannot make you a client without your knowledge and consent.